

KNHM Series

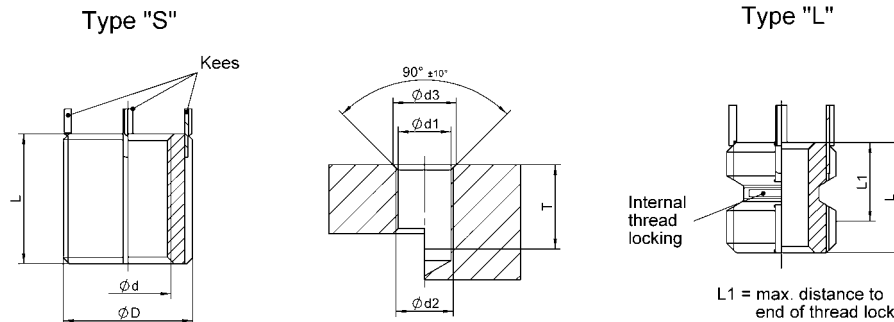

Kees:
Inserts with internal thread size of M6 and under are furnished with 2 locking kees.
Inserts with internal thread of M8 and above are furnished with 4 locking kees.

| Part-no. | | Dimensions | | | | |
|-------------------|------------------|------------|----------|----------------------------------|----------|------|
| Standard type "S" | Locking type "L" | Ø d 5H | Ø D 4h | Shear engagement mm ² | L ± 0,30 | L1 |
| KNHM4X0,7 | | M4X0,7 | M8X1,25 | 104,9 | 8 | 8,0 |
| | KNHML4X0,7 | | | 83,1 | | |
| KNHM5X0,8 | | M5X0,8 | M10X1,25 | 177,1 | 10 | 8,7 |
| | KNHML5X0,8 | | | 152,7 | | |
| KNHM6X1,0 | | M6X1,0 | M12X1,25 | 266,7 | 12 | 9,5 |
| | KNHML6X1,0 | | | 242,5 | | |
| KNHM8X1,25 | | M8X1,25 | M14X1,5 | 341,6 | 14 | 10,0 |
| | KNHML8X1,25 | | | 316,4 | | |
| KNHM10X1,5 | | M10X1,5 | M16X1,5 | 470,2 | 16 | 10,0 |
| | KNHML10X1,5 | | | 441,4 | | |
| KNHM12X1,75 | | M12X1,75 | M18X1,5 | 608,5 | 18 | 10,7 |
| | KNHML12X1,75 | | | 561,8 | | |

| Part-no. | Installation dimensions | | | | Removal dimensions | | |
|--------------|---|-------------------|----------|--------|---------------------------------|-------|-------|
| | d1 Tap drill Ø | d3 Counter-sink Ø | Thread | | Hand installation tool part-no. | Drill | |
| | | | Ø d2 6H | T min. | | Ø | Depth |
| KNHM4X0,7 | 6,90 ^{+0,100} _{-0,025} | 8,25 | M8X1,25 | 9,5 | KRTM4-02 | 5,5 | 4,00 |
| KNHML4X0,7 | | | | | | | |
| KNHM5X0,8 | 8,80 ^{+0,100} _{-0,025} | 10,25 | M10X1,25 | 11,5 | KRTM5-02 | 7,5 | 4,75 |
| KNHML5X0,8 | | | | | | | |
| KNHM6X1,0 | 10,80 ^{+0,100} _{-0,025} | 12,25 | M12X1,25 | 13,5 | KRTM6-02 | 9,5 | 4,75 |
| KNHML6X1,0 | | | | | | | |
| KNHM8X1,25 | 12,80 ^{+0,130} _{-0,025} | 14,25 | M14X1,5 | 15,5 | KRTM8-02 | 11,5 | 4,75 |
| KNHML8X1,25 | | | | | | | |
| KNHM10X1,5 | 14,80 ^{+0,130} _{-0,025} | 16,25 | M16X1,5 | 17,5 | KRTM10-02 | 13,5 | 4,75 |
| KNHML10X1,5 | | | | | | | |
| KNHM12X1,75 | 16,80 ^{+0,130} _{-0,025} | 18,25 | M18X1,5 | 19,5 | KRTM12-02 | 15,5 | 4,75 |
| KNHML12X1,75 | | | | | | | |

KNHM Series

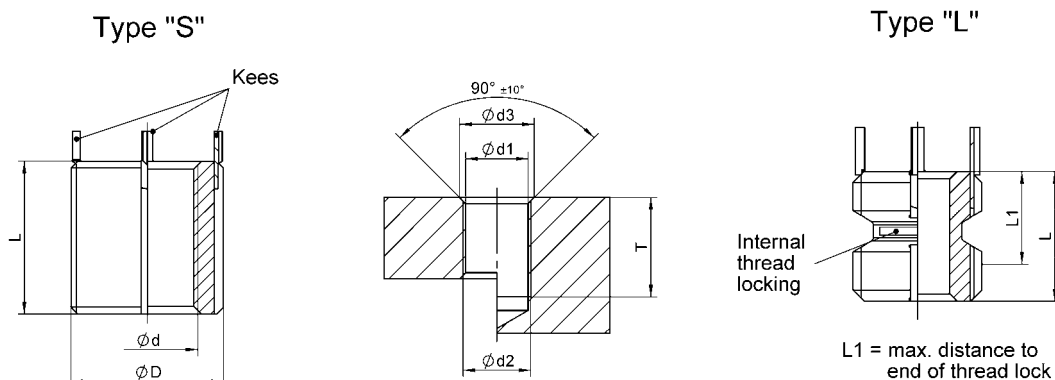

Kees:
Inserts with internal thread size of M6 and under are furnished with 2 locking kees.
Inserts with internal thread of M8 and above are furnished with 4 locking kees.

| Part-no. | | Dimensions | | | | |
|-------------------|------------------|------------|---------|----------------------------------|----------|------|
| Standard type "S" | Locking type "L" | Ø d 5H | Ø D 4h | Shear engagement mm ² | L ± 0,30 | L1 |
| KNHM14X2,0 | | M14X2,0 | M20X1,5 | 770,5 | 20 | 12,4 |
| | KNHML14X2,0 | | | 724,4 | | |
| KNHM16X2,0 | | M16X2,0 | M22X1,5 | 896,8 | 22 | 12,4 |
| | KNHML16X2,0 | | | 855,2 | | |
| KNHM18X1,5 | | M18X1,5 | M24X1,5 | 1084,4 | 24 | 16,8 |
| | KNHML18X1,5 | | | 1051,5 | | |
| KNHM20X2,5 | | M20X2,5 | M30X2,0 | 1774,3 | 30 | 17,5 |
| | KNHML20X2,5 | | | 1736,4 | | |
| KNHM24X3,0 | | M24X3,0 | M33X2,0 | 2189,4 | 33 | 19,0 |
| | KNHML24X3,0 | | | 2161,9 | | |

| Part-no. | Installation dimensions | | | | | Removal dimensions | |
|-------------|---|-------------------|---------|--------|---------------------------------|--------------------|-------|
| | d1 Tap drill Ø | d3 Counter-sink Ø | Thread | | Hand installation tool part-no. | Drill | |
| | | | Ø d2 6H | T min. | | Ø | Depth |
| KNHM14X2,0 | 18,75 ^{+0,130} _{-0,025} | 20,25 | M20X1,5 | 22,5 | KRTM14-02 | 17,50 | 4,75 |
| KNHML14X2,0 | | | | | | | |
| KNHM16X2,0 | 20,50 ^{+0,130} _{-0,025} | 22,25 | M22X1,5 | 24,5 | KRTM16-02 | 17,75 | 4,75 |
| KNHML16X2,0 | | | | | | | |
| KNHM18X1,5 | 22,50 ^{+0,130} _{-0,025} | 24,25 | M24X1,5 | 26,5 | KRTM18-02 | 19,75 | 4,75 |
| KNHML18X1,5 | | | | | | | |
| KNHM20X2,5 | 28,00 ^{+0,130} _{-0,025} | 30,25 | M30X2,0 | 34,5 | KRTM20-02 | 25,75 | 6,35 |
| KNHML20X2,5 | | | | | | | |
| KNHM24X3,0 | 31,00 ^{+0,130} _{-0,025} | 33,25 | M33X2,0 | 37,5 | THM24 | 28,75 | 6,35 |
| KNHML24X3,0 | | | | | | | |